

**Control Unit and Cables EVC-C3  
D11A-A, D11A-B, D11A-C, D11A-C (IPS), D11A-C MP,  
D11A-D MP, D11A-E**

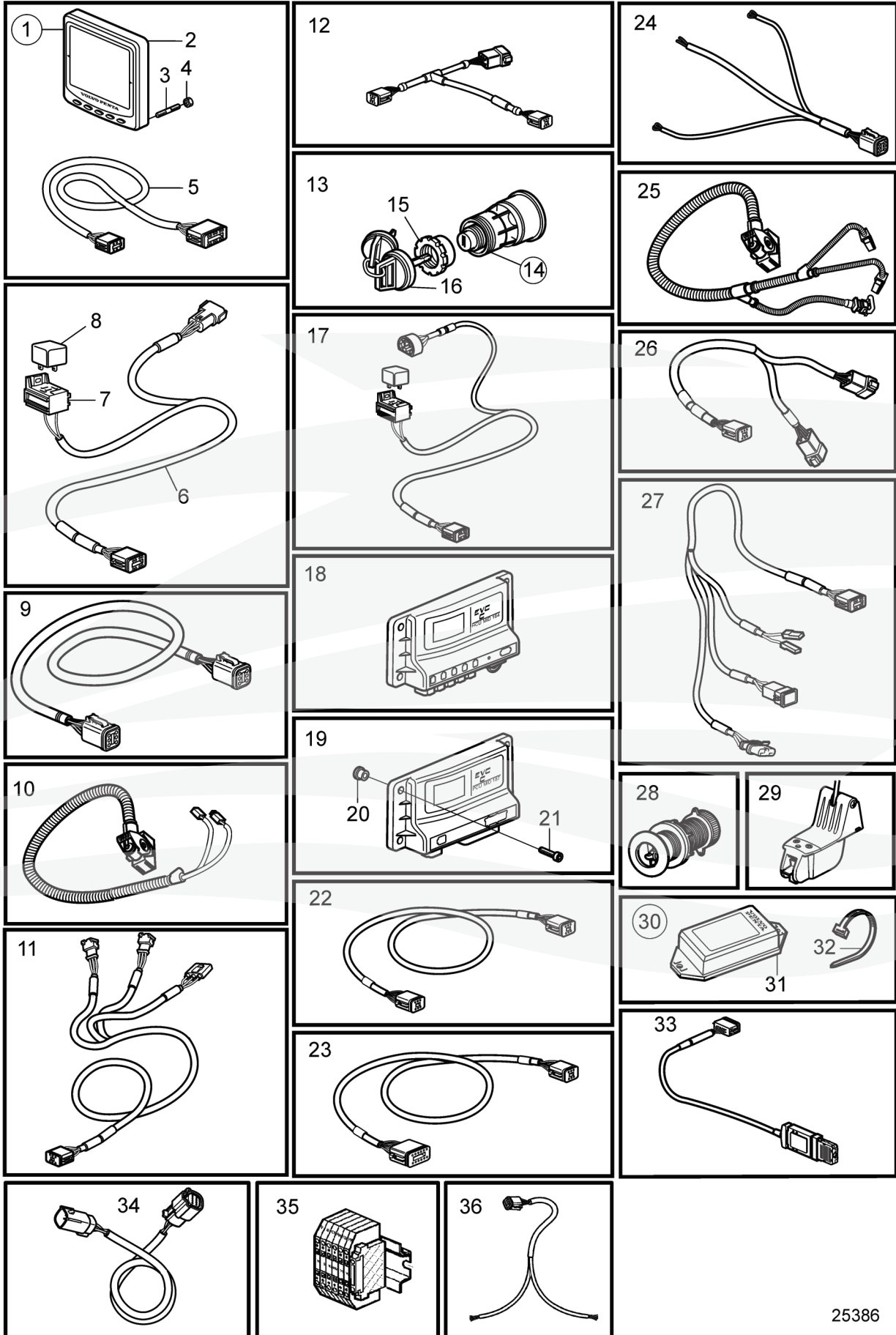

**Control Unit and Cables EVC-C3  
D11A-A, D11A-B, D11A-C, D11A-C (IPS), D11A-C MP,  
D11A-D MP, D11A-E**

REF	PART NO.	QTY	DESCRIPTION
1	21352262	1	Display - Replaced by 21631438
1	21631438	1	Kit
2		1	Display
3	830928	4	Stud
4	830930	4	Wing nut
5	3588207	1	Cable kit
6	881786	1	Cable kit
7	977184	1	Housing
8	873765	1	Relay 12V
8	3171420	1	Relay 24V
9	3842733	1	Extension cable L=3.0m
9	3842734	1	Extension cable L=5.0m
9	3842735	1	Extension cable L=7.0m
9	3842736	1	Extension cable L=9.0m
9	3842737	1	Extension cable L=11.0m
9	21172469	1	Extension cable L=20.0m
9	21172470	1	Extension cable L=40m, Replaced by 22815614
9	22815614	1	Cable kit, 100m Data link cable kit, Type Approved 100m
9	22815615	1	Cable kit, 1000m Data link cable kit, Type Approved 1000m
9	22815617	1	Cable kit, 25m Data link cable kit, Type Approved 25m
9	874789	1	Cable kit PCU-HCU, 6 pole, L=5.0m
9	889550	1	Cable PCU-HCU, 6 pole, L=7.0m
9	889551	1	Cable PCU-HCU, 6 pole, L=9.0m
9	889552	1	Cable PCU-HCU, 6 pole, L=11.0m
9	888013	1	Cable PCU-HCU, 6 pole, L=13.0m
10	40005754	1	Wiring harness Engine-PCU cable., L=2.65m
11	874676	1	Cable kit EVC control lever cable, 6-pole., L=1.5m
12	3588972	1	Cable kit T-connector bus cable, 6-pole., L=0.5m
13	3587070	1	Starter switch, set Kit with 2 key switch with identical key
14	3587071	1	Starter switch
15	859955	1	Plastic nut
16	859953	1	Key State key code when ordering
17	888004	1	Cable, starter switch
18	21321153	1	Control unit, not programmed HCU. Software ordered separately or downloaded with Vodia.

**Control Unit and Cables EVC-C3  
D11A-A, D11A-B, D11A-C, D11A-C (IPS), D11A-C MP,  
D11A-D MP, D11A-E**

REF	PART NO.	QTY	DESCRIPTION
18	3586261	1	Software - Warehouse programming. This p/n can not be ordered, but will be used for invoicing.
18	3586259	1	Software - Vodia-programming. This p/n can not be ordered, but will be used for invoicing.
18	21172467	1	Control unit XCU
19	21339311	1	Control unit, not programmed PCU. Software ordered separately or downloaded with Vodia.
19	3586267	1	Software - Warehouse programming. This p/n can not be ordered, but will be used for invoicing.
19	3586266	1	Software - Vodia-programming. This p/n can not be ordered, but will be used for invoicing.
20	21230875	4	Sleeve
21	946934	4	Flange screw
22	3886666	1	Cable, synchronizing - Synchronizing cable for twin installation. 6 pole., L=1.5m
22	21166002	1	Wiring harness L=7m
22	21166003	1	Wiring harness L=9m
22	21166004	1	Wiring harness L=13m
23	3885343	1	Wiring harness Triple and quadruple installation
24	3807229	1	Wiring harness, fuel
25	40005753	1	Wiring harness
26	3588206	1	Cable kit, y-split - For connecting extra equipment to Multilink
27	3808852	1	Cable kit, instruments, panels
28	3587054	1	Sensor Through hull
29	3587055	1	Sensor Mounted on transom
30	21281264	1	Converter Obsolete part
31		1	Converter
32	948211	2	Cable tie
33	21509941	1	Control unit
34	22739429	1	Wiring harness - Cable, Single data link, 3m, Type Approved
34	22810677	1	Wiring harness Cable, Single data link, 11m, Type Approved
34	23650460	1	Wiring harness Cable, Single data link, 0,5m, Type Approved
35	22797159	1	Terminal block Terminal block, Type Approved
36	22739427	1	Wiring harness Y-split data link cable, Type Approved